

Garden GLOW

Presented by

WELLS FARGO



Scan for a digital map

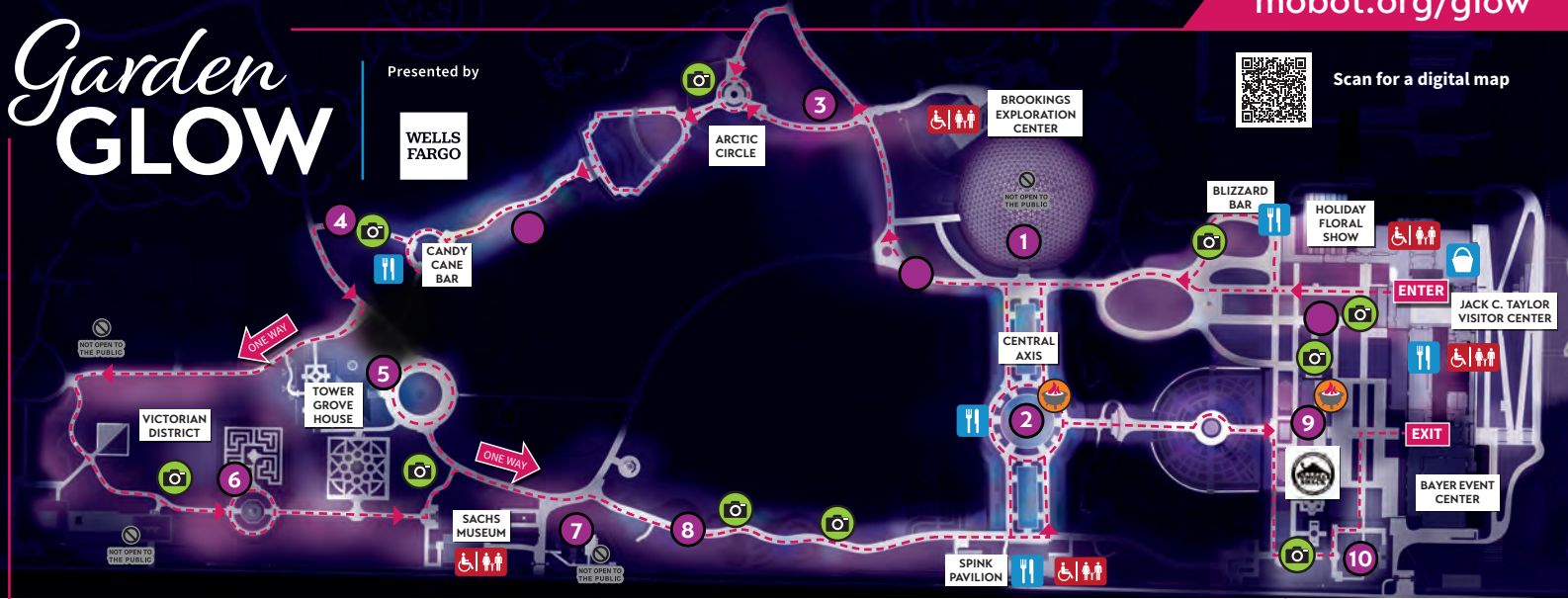

SPONSORED EXHIBITS

- | | | | | |
|---|--|---|--|---|
| <p>1 Illumitron
Sponsored by
The H-J Family of Companies</p> | <p>3 Botanical Luminaries
Sponsored by
Amundsen Davis LLP</p> | <p>5 Candlelight Village
Sponsored by
Ameren</p> | <p>7 Holiday House
Sponsored by
JiaMin and Michael Dierberg</p> | <p>9 Linnean Lights
Sponsored by
Kathy and David Hollo</p> |
| <p>2 Fire and Light
Sponsored by
Wells Fargo</p> | <p>4 Twinkling Tunnel
Sponsored by
The Boeing Company</p> | <p>6 Labyrinth of Light
Sponsored by
Elizabeth Green</p> | <p>8 Frosted Forest
Sponsored by
Leia J. and David N. Farr</p> | <p>10 Gleaming Ottoman Garden
Sponsored by
Graybar</p> |

KEY

- Sponsored Exhibit
- Exhibit
- Photo Op
- Warming Station
- Food or Beverage
- Shopping
- Accessible and Family Restrooms
- S'More Shack

Garden GLOW

Presented by

WELLS
FARGO

NOVEMBER 18

THROUGH

JANUARY 6

Closed November 23, 27,
and December 24–25

EXHIBITION SPONSOR

The H-J Family of Companies

SIGNATURE LOCATION SPONSORS

Ameren | Lelia J. and David N. Farr

SPECIAL VENUE SPONSORS

Amundsen Davis LLP | The Boeing Company
JiaMin and Michael Dierberg | Graybar
Elizabeth Green | David and Kathy Hollo

ADDITIONAL SPONSORSHIP BY

Clayton Financial Group | Commerce Bank
Kathy and Rob Williams

DINING

Dine and Glow

located in Sassafras

Adults \$18, Children \$9

Includes entree, side, drink,
and treat (child only).

Glow ticket purchase required. Last entry at 8 p.m.

Festive drinks*

Blizzard Bar, Fire and Light S'mores,
Candy Cane Bar, Café Flora, Sassafras,
and Emporium.

**Hours of operation subject to change at all bars*

S'more kits

Fire and Light, Central Axis

Festive food and treats

Café Flora, Sassafras, and S'more Shack.

GIFT SHOP

located in the Jack C. Taylor Visitor Center

**Your visit helps the Garden
protect the future of plant life.
Thank you!**

MEMBERSHIP

**Apply a portion of your Garden
Glow tickets toward membership!**

Garden members enjoy free daytime
admission to Missouri Botanical Garden,
Shaw Nature Reserve, and Sophia M.
Sachs Butterfly House, PLUS exclusive
events and valuable savings on classes,
shopping, and special events like Garden
Glow. Visit the Ticket Counter in the
Taylor Visitor Center to learn more.

PRIVATE FIRE PITS

**Rent a private fire pit, with
s'mores and hot cocoa,
for up to 20 guests.**

Learn more at mobot.org/glow.

*Limited availability. Must be reserved 72 hours in
advance of your visit. Glow ticket purchase required.*

GROUPS

Give the gift of Glow

Groups save more! Discounts start
at 15+ tickets reserved. Buy online
at mobot.org/glow.



MISSOURI BOTANICAL GARDEN

4344 Shaw Blvd. | St. Louis, MO 63110 | (314) 577-5100 | mobot.org